

# FORCE™ 10 TYPHOON™

## TWIN CARTRIDGE FULL FACE RESPIRATOR

PRODUCT CODE: BPB003-\_04-000

ONE OF THE LIGHTEST, MOST WELL BALANCED CLASS 1 FULL FACE MASKS AVAILABLE

### TECHNICAL SPECIFICATION

### RESPIRATORY PROTECTION

#### INSTRUCTIONS FOR USE

Fully loosen all four head straps, then place the harness at back of head and position facepiece over the face

Pull the ends of the four straps to adjust tightness, starting with the neck straps first, then the forehead straps. Do not over tighten the head straps

Perform a positive/or negative pressure fit check each time the respirator is donned



#### LENS:

Polycarbonate. Panoramic Anti-Mist, Anti-Scratch design

#### ORINASAL:

Thermoplastic Elastomer and polypropylene

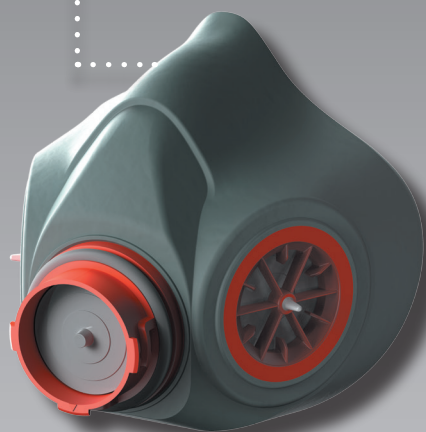

#### TYPHOON EXHALATION VALVE:

##### VALVE:

Polycarbonate valve casing and silicon diaphragm

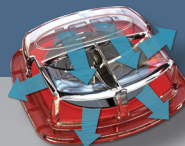

#### HEAD HARNESS:

Thermoplastic Elastomer harness and ABS Buckles

#### CLEANING & MAINTENANCE

Disassemble by removing the filters

The centre adapter, lens and face seal can also be removed if necessary

Clean and sanitise the facepiece (excluding cartridges and filters) by immersing in warm cleaning solution and scrub with soft brush until clean. Parts may also be cleaned in a washer

Disinfect respirator by soaking in a solution of quaternary ammonium disinfectant or sodium hypochlorite (50ppm chlorine)

Rinse in fresh, warm water and air dry in a non-contaminated atmosphere. Drying temperatures must not exceed 50°C

Respirator components, especially exhalation valve and seat, should be inspected prior to each use. Any damaged or deteriorated components should be replaced

The cleaned respirator should be stored at ambient temperature in a dry non-contaminated atmosphere



#### CONFORMITY

Tested to the relevant European Standards (EN136 (Class 1), EN143, EN14387) and have met the requirements shown below:

Facepiece EN136

Gas Filter Performance EN14387

Particulate Filter Performance EN143

Flammability EN136

EC Type Examination Certificate number 683396



MANUFACTURING FOR SAFETY  
WWW.JSP.CO.UK



UKSALES@JSP.CO.UK  
TEL: +44 (0)1993 826050



# FORCE™ 10 TYPHOON™

## TWIN CARTRIDGE FULL FACE RESPIRATOR

PRODUCT CODE: BPB003-\_04-000

ONE OF THE LIGHTEST, MOST WELL BALANCED CLASS 1 FULL FACE MASKS AVAILABLE

### TECHNICAL SPECIFICATION

#### RESPIRATORY PROTECTION

#### DIMENSIONS OF INNER PACKAGING

Quantity: 1

Weight (Small): 565g (Approx.)

Weight (Medium): 570g (Approx.)

Weight (Large): 580g (Approx.)

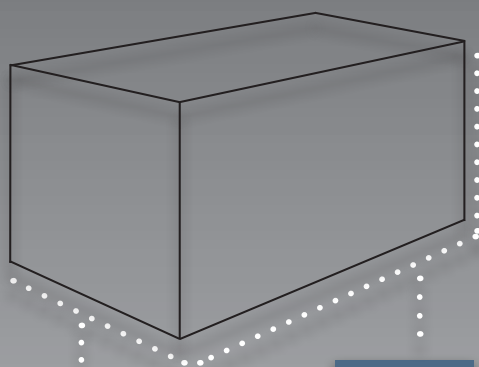

**HEIGHT:**  
190mm

**LENGTH:**  
225mm

**WIDTH:**  
145mm

#### DIMENSIONS OF OUTER PACKAGING

Quantity: 10

Weight (Small): 6.6kg (Approx.)

Weight (Medium): 6.7kg (Approx.)

Weight (Large): 6.8kg (Approx.)

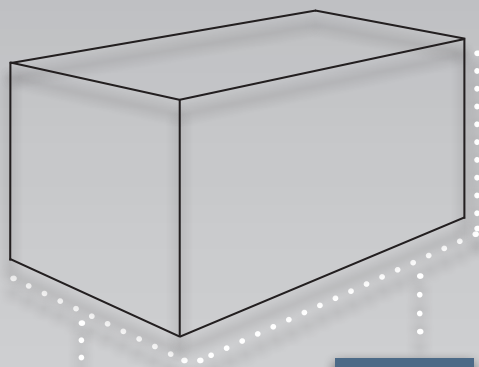

**HEIGHT:**  
210mm

**LENGTH:**  
745mm

**WIDTH:**  
470mm

#### DIMENSIONS OF RESPIRATOR

Available in small, medium and large

Weight without filters: 370g (Approx.)

#### LIMITATIONS OF USE

These respirators do not supply oxygen  
Do not use in oxygen deficient atmospheres

Do not use for respiratory protection against atmospheric contaminants which have poor warning properties, are unknown or immediately dangerous to life and health or against chemicals which generate high heats of reaction with chemical filters

Do not modify or alter this device

The assembled respirator may not provide a satisfactory face seal with certain physical characteristics (such as beards or large side burns) resulting in leakage between the facepiece and the face, the user assumes all risks of bodily injury which may possibly result

Do not use with unknown concentrations of contaminants

Use strictly in accordance with face piece and filter instruction leaflet

#### FIT TESTING

The Force™ 10 Typhoon™ Full Face Mask Respirator is a tight fitting facepiece and therefore requires a fit test per wearer before use as per the COSHH regulations 2002



MANUFACTURING FOR SAFETY  
WWW.JSP.CO.UK

UKSALES@JSP.CO.UK  
TEL: +44 (0)1993 826050

